

GAS PLANCHA HIGH-TEMP COOK SURFACE

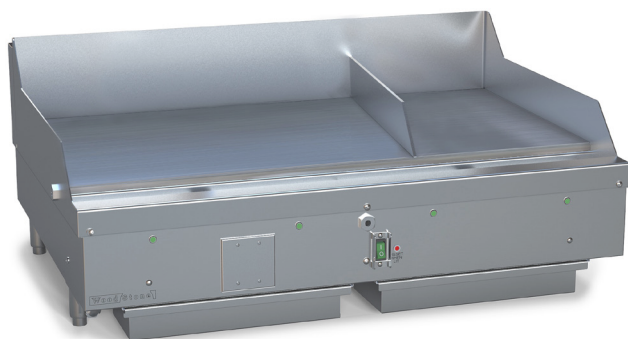

Job Name	Chipotle
Model	WS-PL-4836-4-CT-RIGHT
Item#	

The Wood Stone Gas Plancha features a small footprint that measures 48 inches x 35 inches with a smooth steel cooking surface 48 inches x 24 inches. Supported by four legs, it is intended for installation on a suitable countertop or on the optional stand available from Wood Stone.

The surface of the Gas Plancha can be used as a direct contact cooking surface like a griddle for searing or sauteing, or heated up to 750° F so that it functions more like an open burner or French Top.

The cook surface is divided into two zones, a main zone and a smaller zone separated by a divider that can be used for specialty items. Specify left or right for the preferred divider location. Each zone is equipped with its own temperature control. On this model, the temperature control knobs are located behind a removable cover. The plancha utilizes a proprietary control system developed by Wood Stone which provides even temperature control across the entire cook surface with no heat-recovery issues.

The Gas Plancha arrives completely assembled, ETL Listed, ready to install, and is made in the USA.



t. 360.650.1111
tf. 800.988.8103
f. 360.650.1166

Wood Stone Corporation
1801 W. Bakerview Rd.
Bellingham, WA 98226 USA
info@woodstone-corp.com
woodstone-corp.com

REVISED: SUMMER 2014

An ongoing program of product improvement may require us to change specifications without notice.



GAS PLANCHA

HIGH-TEMPERATURE COOK SURFACE • WS-PL-4836-4-CT-RIGHT

PLAN VIEW

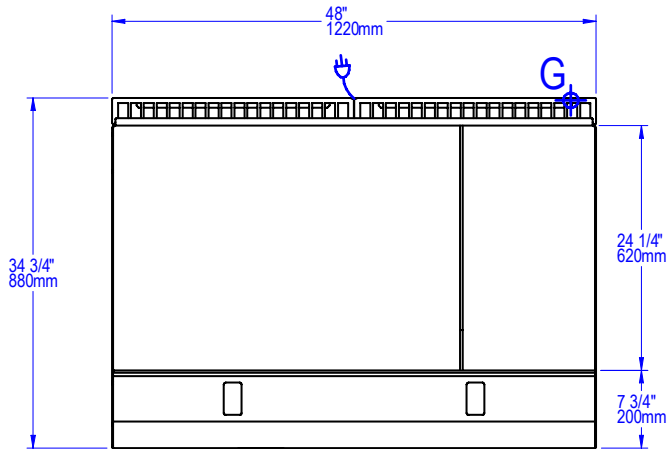

FRONT VIEW

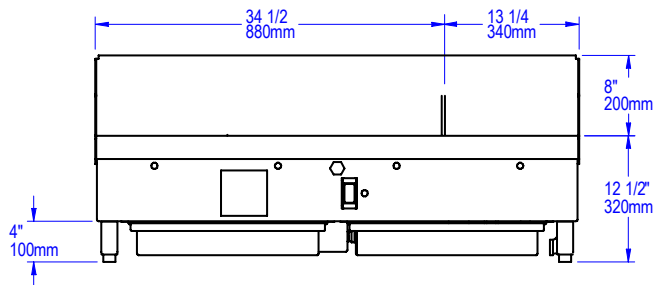

WITH OPTIONAL STAND
FRONT

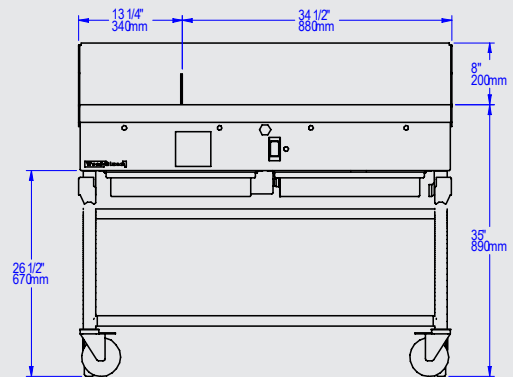

SIDE

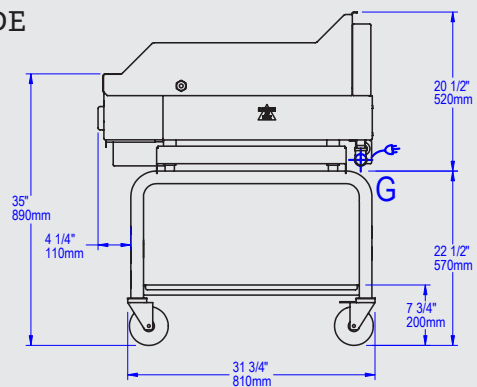

SIDE VIEW

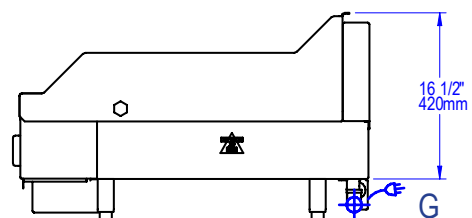

UTILITIES SPECIFICATIONS

GAS
3/4 inch gas inlet (FNPT)
107,000 BTU/hr - Natural Gas (NG)
OR
107,000 BTU/hr - Propane (LP)

ELECTRICAL
120 VAC, 0.7A, 50/60 Hz, 1 Phase
Equipped with a NEMA 5-15P plug
for use with a standard 120 VAC,
15 A or 20 A outlet.
Refer to data plate when installing

VENTING INFORMATION

The Wood Stone Gas Plancha must be vented with a Listed Type 1 exhaust hood, or one constructed in accordance with NFPA 96 and all relevant local and national codes. The oven must be vented in accordance with all relevant local and national codes, and in a manner acceptable to the authority having jurisdiction.

Unit Shipping Weight: 580 lbs.

REVISED: SUMMER 2014

An ongoing program of product improvement may require us to change specifications without notice.



t. 360.650.1111
tf. 800.988.8103
f. 360.650.1166

Wood Stone Corporation
1801 W. Bakerview Rd.
Bellingham, WA 98226 USA
info@woodstone-corp.com
woodstone-corp.com

Wood Stone